

## TY Model 3-2 Balsa Wood RC Airplane Install Manual

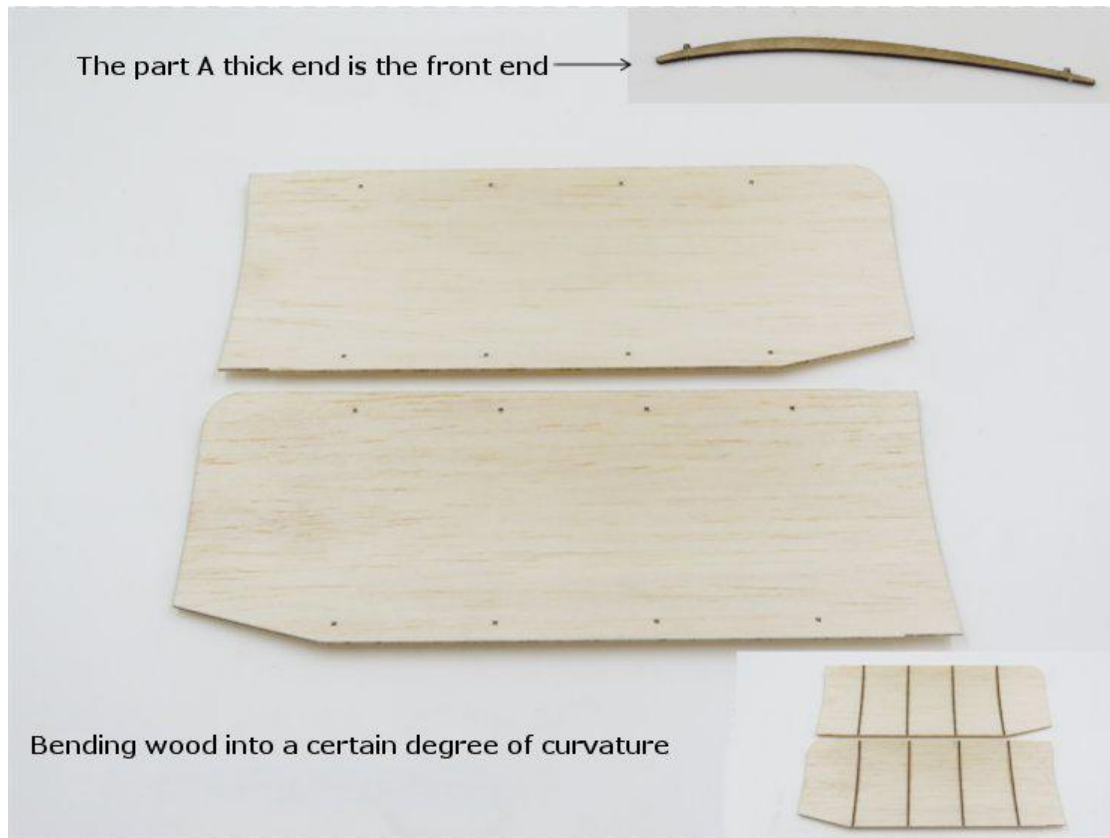



Tighten the screws 1x3mm



Use part H to adjust wing table distance



2mm Fuselage carbon rod



Paste Part G-B-C

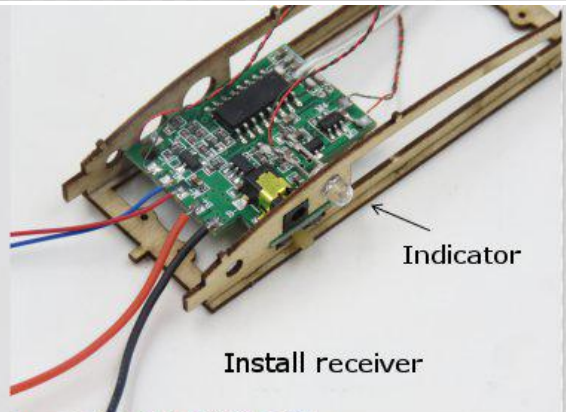

Install receiver

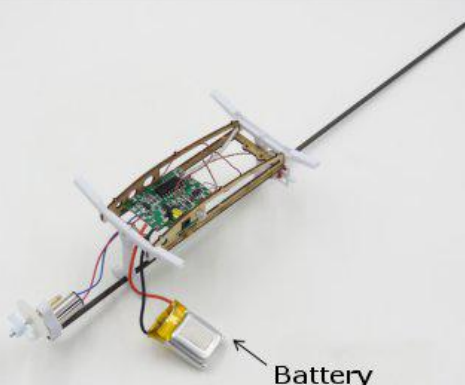

Battery



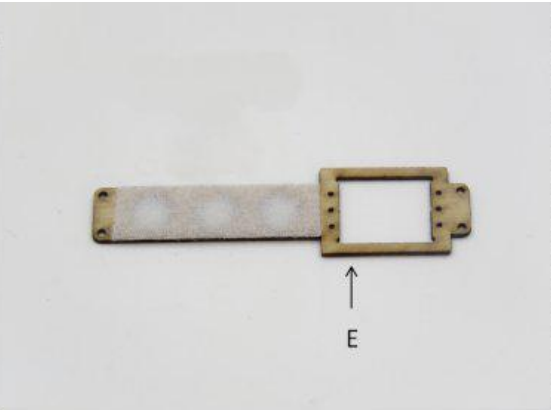
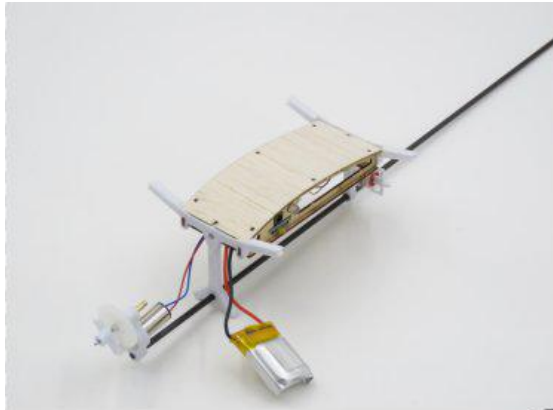

Fix the part E with screws

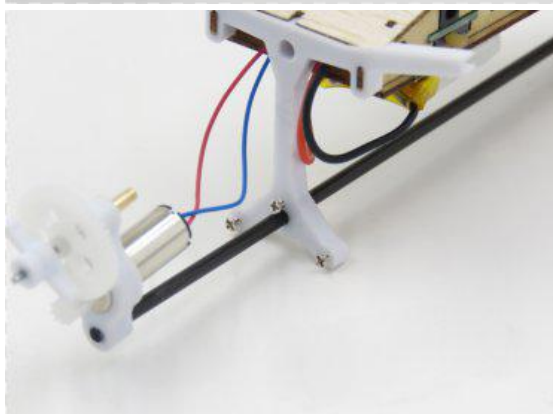
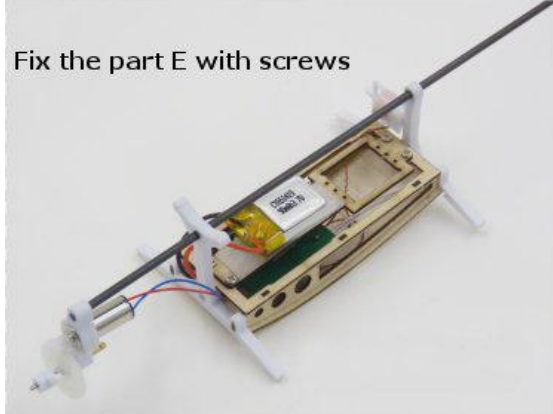

Paste Part F-J

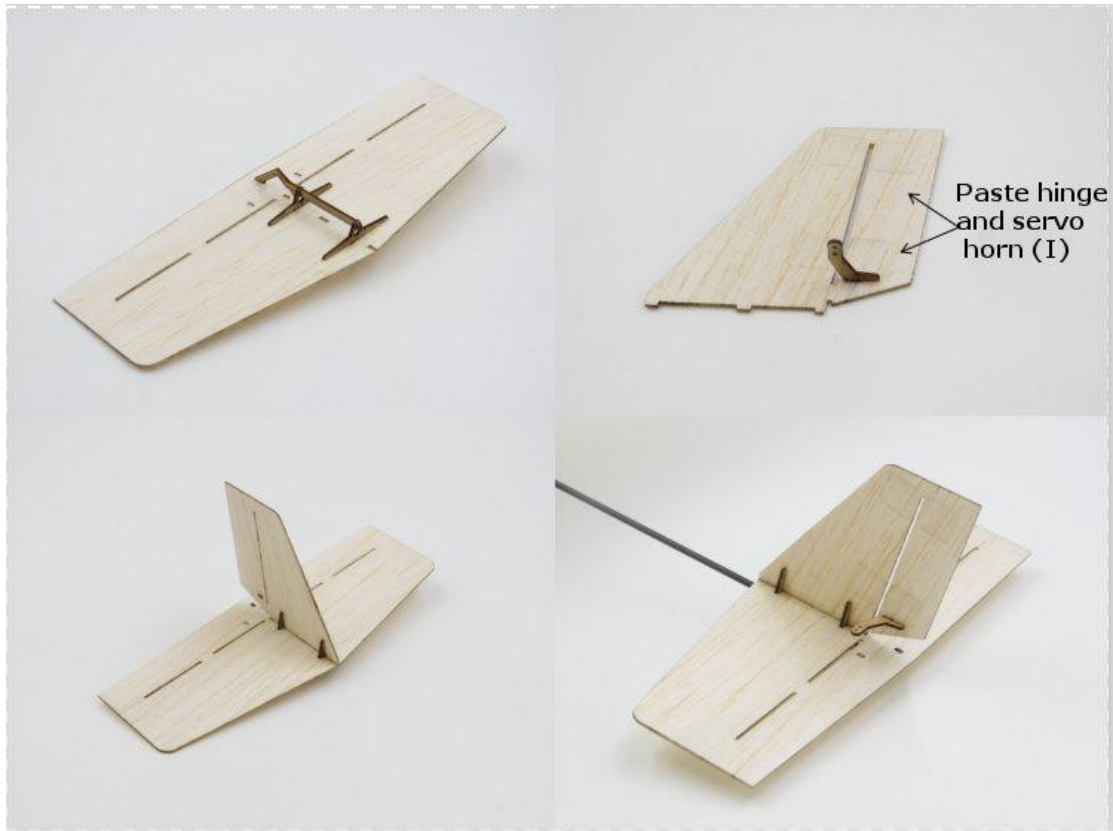

Paste hinge and servo horn (I)

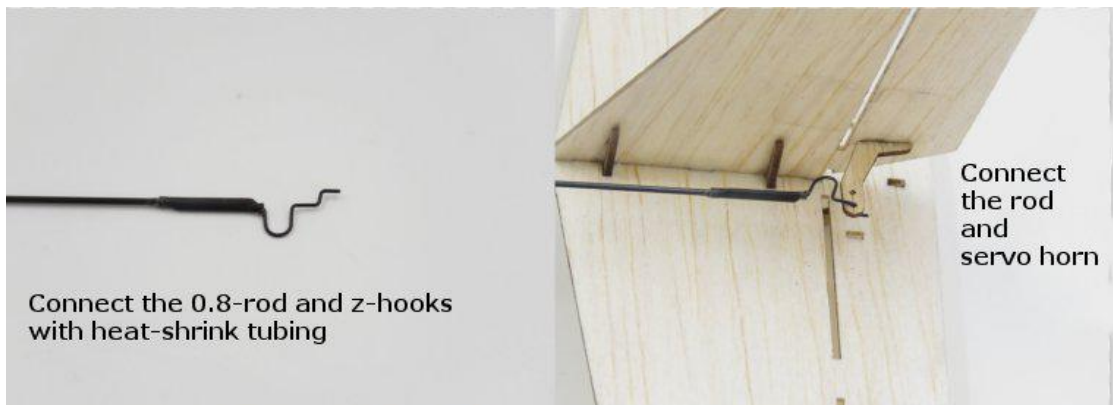

Connect the 0.8-rod and z-hooks with heat-shrink tubing

Connect the rod and servo horn

