



# SPG ©

3-Axis Stabilized Handheld Gimbal  
for Smartphone

GuiLin FeiYu Technology Incorporated Company

Instruction Manual V1.2

# 1. Product Overview

\* The showing smartphone is only for reference

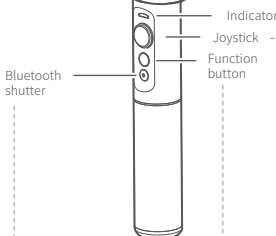
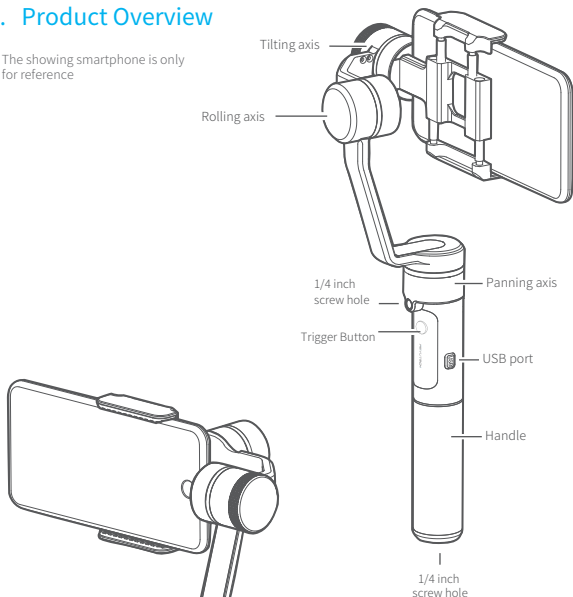

Indicator Status	Mode / Status
Blue light flashes once	Panning mode
Blue light flashes twice	Panning and Tilting mode
Blue light flashes three times	Standby
Blue light constant on	Lock mode / Initializing
Blue light keeps flashing	Initialization failure / Malfunction
Red light flashes three times	Low battery
Red light keeps flashing	Switching to standby mode/ Gimbal will power off

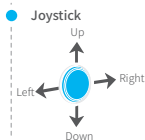

## Bluetooth shutter

Button	Mode/Status
Single tap	Green light flasher/ Photo
Long press	Green light constant on/ Video

Explanation: Press and hold the Bluetooth shutter to power on to empty the Bluetooth when smartphone did not connect gimbal.

## Function Button

You can use the function button to switch the working mode, power on or power off the gimbal.

Please refer to "Modes / Functions".

## Package List



Heavy Counter Weight X1



Counter Weight X1



USB cable X1



Batteries (Type:22650)X1

## 2. User Guide

### Attention !

- (1) Please install the smartphone before powering on the gimbal
- (2) When not in use, turn off the gimbal and then remove the smartphone

### 1 Charging

Please make sure the battery is fully charged before you use the gimbal for the first time.

Option 1: Charge with USB cable.

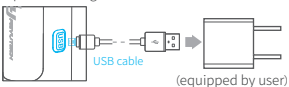

Option 2: remove the battery and charge the battery with charger (equipped by user).

### 2 Install the battery

Remove the handle and insert one 22650 battery into it.

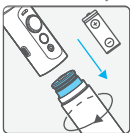

### 3 Install the smartphone

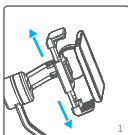

1 Attach the smartphone with the quick-release adapter, and ensure it is secure.

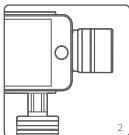

2 Without counter weight  
Phone weight < 165g  
Such as: iPhone 5 / 5s

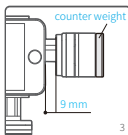

3 With counter weight  
180g < Phone weight ≤ 194g  
Such as: iPhone 6s / 6

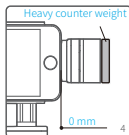

4 With Heavy counter weight  
Phone weight > 194g  
Such as: iPhone 7/7 Plus / 6 Plus

▲ Tips: Please take off the protective casing of the smartphone before installation.

\*If it is not balanced after you finished above operation instructions, please follow step 4 to balance it again.

### 4 Balance Adjustment

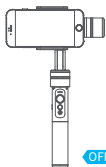

Best Balance

#### How to balance adjustment

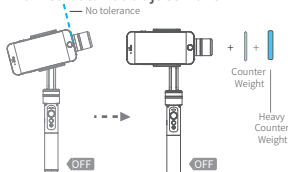

If there is no tolerance between smartphone and tilting axis, but the smartphone still inclines to the left, please replace the heavy counter weight or add the counter weight.

If there is no tolerance between smartphone and tilting axis, but the smartphone still inclines to the right, please replace the heavy counter weight or remove the counter weight.

### 5 Power on / off

**Power on:** Press and hold function button until the green light is on.

**Power off:** Press and hold function button until the red light changes from quick flashing to always on.



Attention: Turn the gimbal on after the phone has been secured properly.

In case of low battery, the indicator will flash red 3 times every 5 seconds. Please charge SPG Live or replace the battery.

### 6 Connecting App

Start the App on your smartphone, follow the instructions to connect the smartphone with gimbal via Bluetooth.

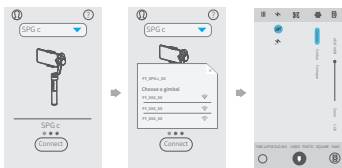

Tips: the shutter button is only functional when the gimbal is connect with smartphone App.

## 3. Modes / Functions

### Working Modes

#### Panning Mode

Tilting and rolling direction are fixed, and the camera lens moves according to the hand

\* Boot default mode: Panning mode

#### Panning and Tilting Mode

The rolling direction is fixed, and the camera lens moves according to the hand movement of the user.

#### Lock Mode

The orientation of the camera is fixed.

# Mode / Function Operation Instructions

Function Button	Function	Explanation
Single tap	Panning Mode / Lock Mode	Single tap to switch between panning mode and lock mode
Double tap	Panning and Tilting Mode	Under panning and tilting mode, single tap to switch to lock mode
Triple tap	Rotate 180° in horizontal	Make the lens rotate 180°
Quadruple tap	Reset	Reset the tilting axis of the gimbal to initial orientation and initial mode
Long press until the red light flashes quickly	Standby	Single tap again to awake the gimbal, or triple tap to initialize the gimbal

  

Trigger Button	Function	Explanation
Long press	Lock Mode	Enter the lock mode, release it to return to before mode
Long press + joystick up and down	Control the App Lens Zoom	Joystick up and down to control the App lens zoom; left and right to control the panning
Double tap	Panning Reset	Restore the initial follow state of the panning

## 4. Firmware Upgrade

(1) Option 1: connect the gimbal with PC via micro USB cable, and then upgrade the firmware.

Please visit the official website [www.feiyu-tech.com](http://www.feiyu-tech.com) to download the relevant programs for upgrading, including USB driver, firmware upgrade software and product firmware, and install the relevant software, decompress the firmware files for standby application.

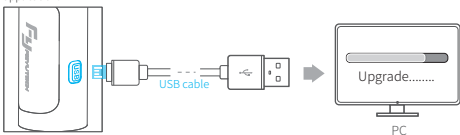

(2) Option 2: connect the gimbal with smartphone via bluetooth, and then upgrade the firmware.



## 5. Gimbal initialization

You can initialize your gimbal when:

- (1) when camera is not level
- (2) if not used for a long period of time
- (3) in case of extreme temperature variations

Adjusting steps:

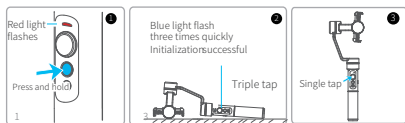

① Long press function button and release it until the red light flash the gimbal enter standby mode, the blue light will flash 3 times periodically.

② Lay the gimbal on a static flat surface and triple tap function button. Initialization is successful when the blue light changes from constant on to flashing 3 times periodically.

③ Click again to wake up the gimbal.

## 6. Parameters

Titling Angle	320°	Titling Increments	min 2°/s max 75°/s
Rolling Angle	320°	Panning Increments	min 3°/s max 150°/s
Panning Angle	360°	Usage time	7 Hours
Adaption	iPhone series / HUAWEI P9 / HUAWEI P9 Plus / Mi 5 / MEIZU MX6 / SAMSUNG NOTE 5 / S7 or other smartphones with the similar dimensions		
Weight	355g (not including battery and smartphone)		

### DISCLAIMER

Prohibit any user for any illegal purpose. Users will be responsible for all behaviors of purchase and use products.

The Company assumes no liability for any risks related to or resulting from the debug and use of this product (including the direct, indirect or third-party losses).

For any unknown sources of using, we will not be at any services.

The updating and changes of product firmware and program may cause changes in function descriptions in this user manual, please read the instructions carefully before upgrading the firmware and use the corresponding user manual.

You can get the latest user manual from the official website: [www.feiyu-tech.com](http://www.feiyu-tech.com)

Feiyu Tech reserves the right to amend this manual and the terms and conditions of use the product at any time.

Due to software and hardware improvements, your actual product might differ from the descriptions and pictures in this user manual. You can get the latest user manual from the official website.

### Attention

- Please correctly assemble the gimbal in accordance with the diagram.
- Please install the iPhone before powering on the gimbal.
- When the gimbal is not in use or placed on the table, please ensure it is powered off.

GuiLin FeiYu Technology Incorporated Company

Website: [www.feiyu-tech.com](http://www.feiyu-tech.com)

E-mail: [service@feiyu-tech.com](mailto:service@feiyu-tech.com)

Tel: +86 (0)773 2320866

