

TITAN installation instruction

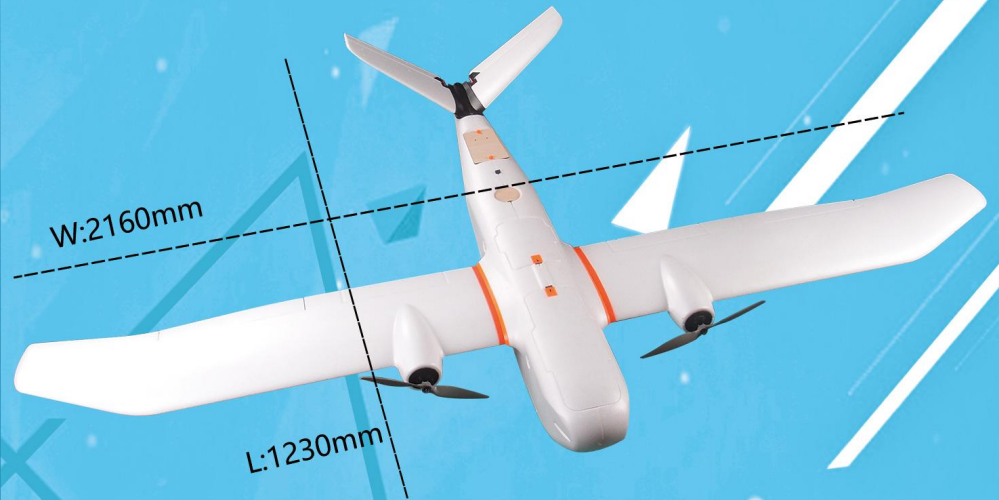

CG: From wingsleading edge to backward 110-115mm

Brand	Skywalker	Wing area	52.5dm ²
Model	TITAN	Flying weight	4500-6000g
Material	Imported EPO	Take off	Hand cast, Catapult
Wingspan	2160mm	Landing	Glide down
Fuselage	1230mm	CG	From Wingsleading edge to backward 110-115mm

Recommended Configuration

Motor	2820KV650	Propeller	1170 E/EP
ESC	40A	Battery	6S 16000-32000mah
Servo	17g*2pcs&9g*2pcs	Radio	4CH

Photos are only reference, please note the real item.

Componntns:

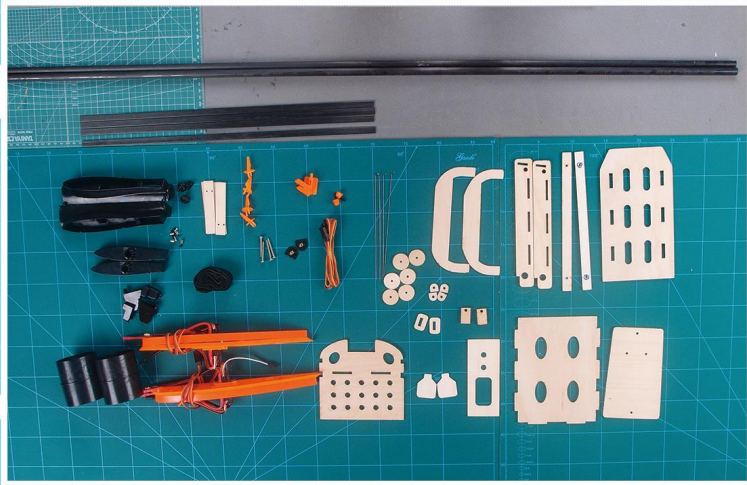

Components :

Fuselage plastic parts (1 set)
 Fuselage plywood (1 set)
 Quick connector parts(2 pairs)
 Canopy pin(2pcs)
 60cm servo extended wire(2 pcs)

Quick adjustor(4pcs)
 16cm pulling rod(4pcs)
 3mm*10mm screws(2pcs)
 3mm*30mm screws(4pcs)
 2mm*7mm screws(2pcs)
 3mm*12mm screws(8pcs)

Foam parts:

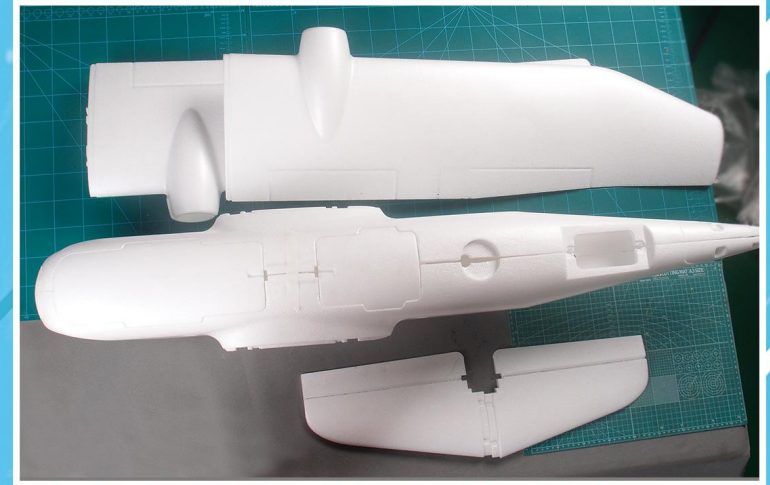

Foam parts :

Fuselage : 1pcs
 Wings : 1 pair
 Tail : 1 pair

Assembling steps

In the process of assembling, adhere the foam KIT and other accessories by glue.

Note: Air-dry the adhesive part if its surface is flat, There is no need to wait for air-dry if its surface is roughness.

Components installation

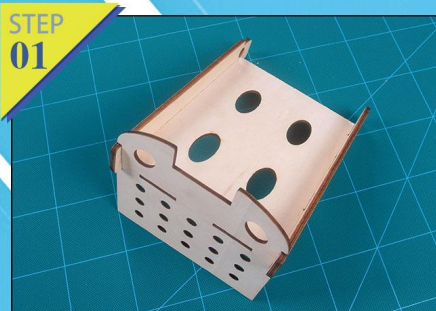

Fig.1-2: Assemble plywood of flight controller cabin and fix it by glue.

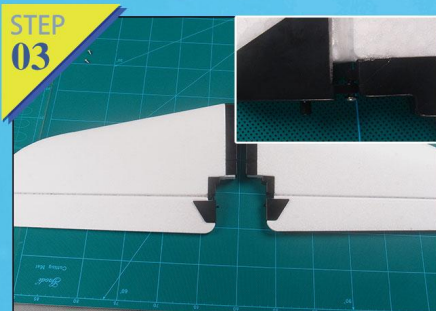

Fig.3-4: Use screws to connect the control surface of V tail. Adhere glue on the parachute canopy.

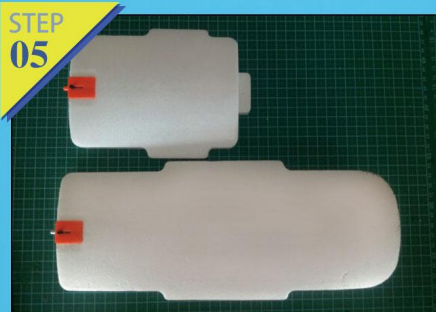
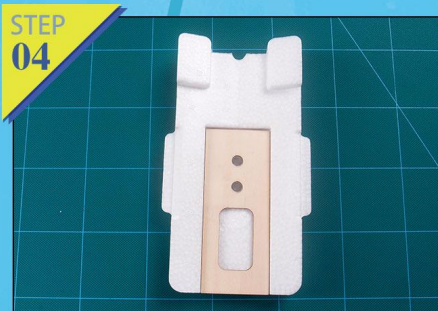
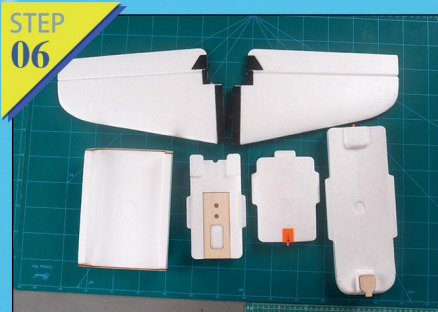

Fig.5-6: Adhere well orange pins by glue and confirm camera cabin, flight controller cabin, nose and parachute canopy, V tails.



Assembling steps

Wings quick connection components installation

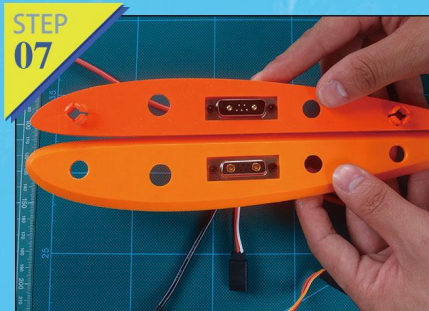

Fig.7-8: Make sure all wires of the connector are right, glue its surface and air-dry for about 2min.

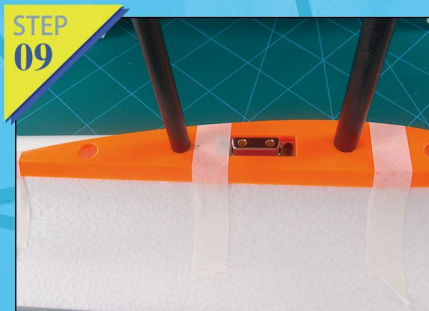

Fig.9-10: Place the wing connector on the fuselage by glue and fix them by tape. Then, fix the other side of wing connector by the same way. Clamp the flight controller cabin into the fuselage.

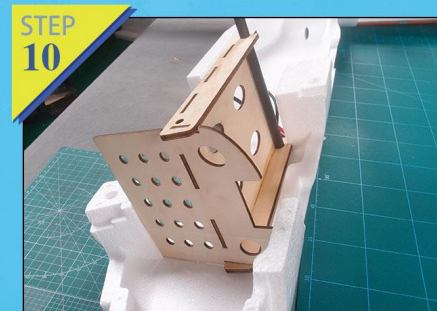

Fig.11-12: Insert carbon fiber tube into fuselage, after air-dry for a while, drag the tube out from the fuselage.



Assembling steps

Wings and Aileron's servo test and Installation

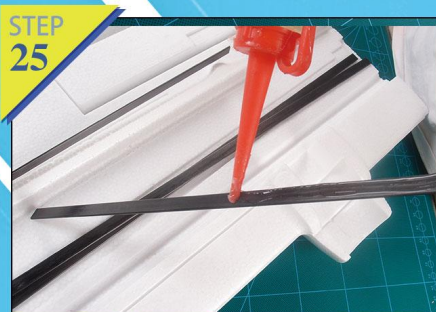

Fig.25-26:Apply glue on the carbon plate, use a cloth to cleanse unnecessary glue when inserting into slot.

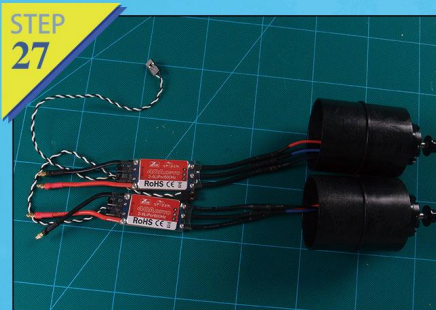

Fig.27-28:Connect well the wire between ESC and motor(atten), adhere glue to motor protector shell and place it on the motor position.

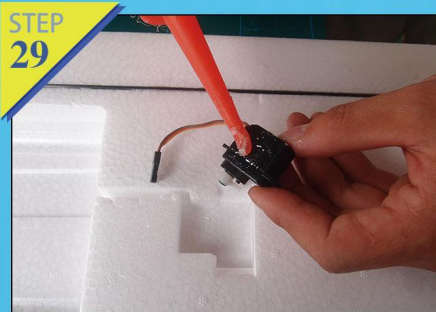
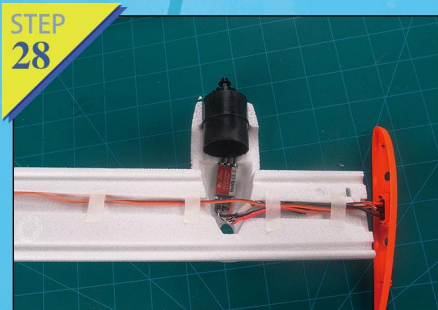
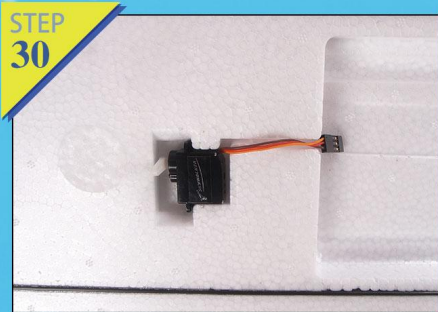

Fig.29-30:Adhere glue on the servo, air-dry it for 2 , and then place it into fixed position. Pay attention to the layout of wires as figure.



Assembling steps

Wings and Aileron's servo test and Installation

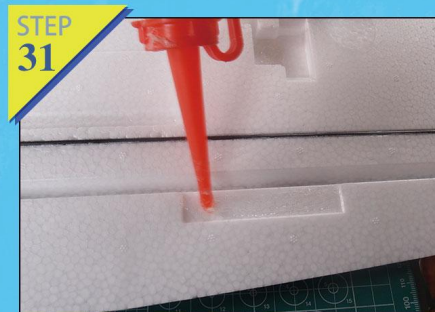

Fig.31-32:Apply glue and place the chip into the slot.

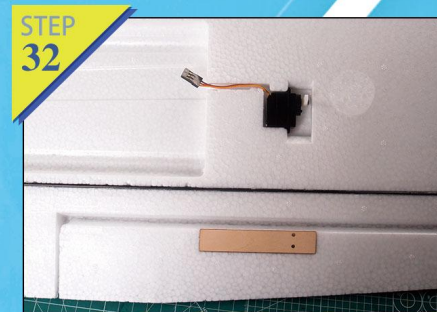

Fig.33-34:Daub glue on the clip to fix servo horn, and adhere glue to the slot of wings(Attention:Glue corner of slot to make sure it is better to glue well).

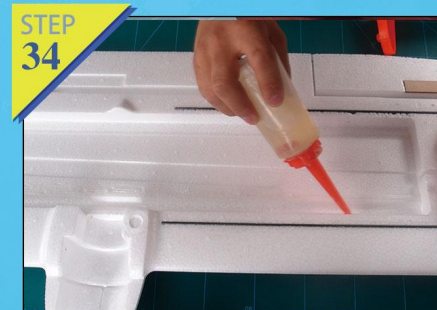
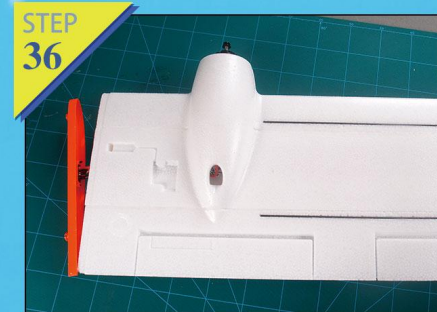

Fig.35-36:Daub the other side of motor protector shell by glue and bond wings together(Attention: align the sideline with motor protector shell and foam. You need to adjust according to the real situation).



Assembling steps

Wings Installation

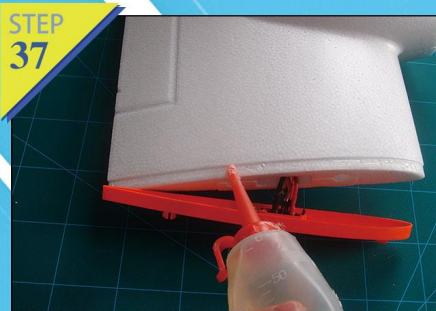

Fig.37-38: Daub glue on quick connector and fuselage, after air-dry for 2, glue them together.

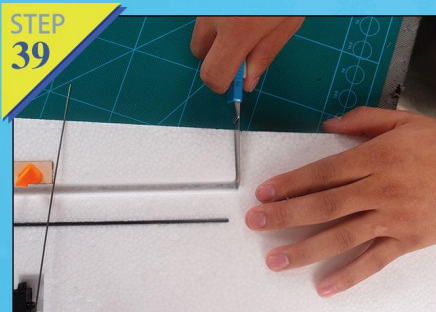
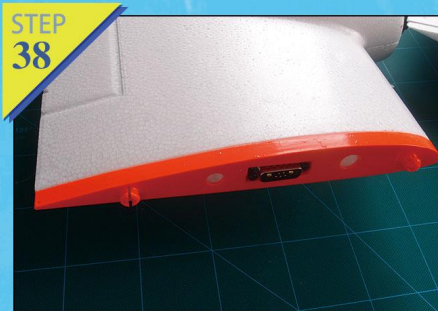

Fig.39-40: Trim servo surface by knife and cut unnecessary steel length.

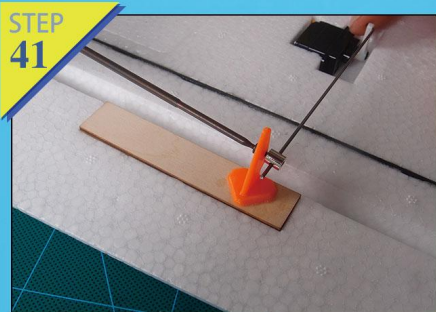
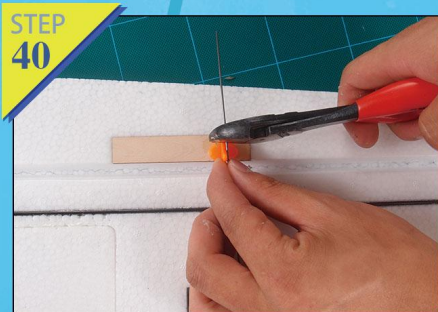

Fig.41-42: Use allocated screws to fix servo horn and pulling rod. The same way to install on both side of wings.



Assembling steps

Fuselage Installation

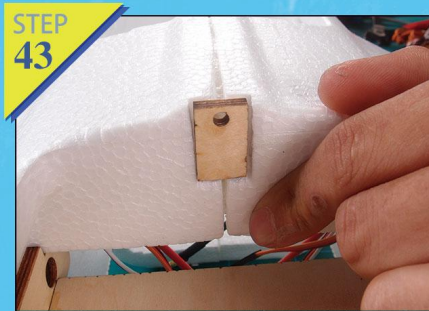

Fig.43-44: Glue the pin fixed plate (install the wood piece according to the reserved position).



Fig.45-46: The throttle connects white wire, servo signal wire connects yellow wire, yellow wire connects aileron servo, white connects ESC signal, use Y wires to connect two yellow wires and use Y wire is paralleled with throttle, then take out UBEC from power.

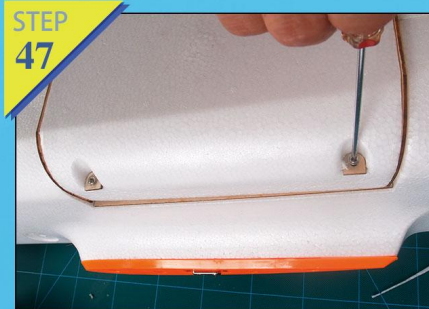
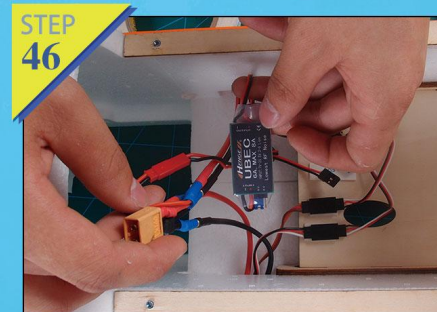

Fig.47-48: Use 4 screws (3mm*30mm) to fix camera canopy.



Assembling steps

Fuselage Installation

STEP
49



STEP
50

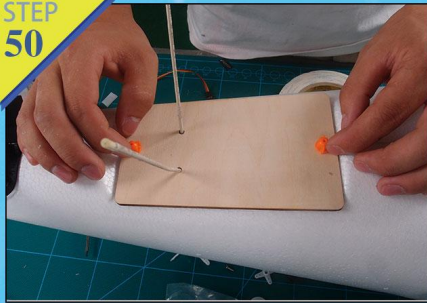

Fig.49-50:Adhere receiver to the plywood and fix the plywood by screws.

STEP
51



STEP
52



Fig.51-52:Daub the glue on the battery replacement plywood and reserved position respectively, and then joint them together after 2min .

STEP
53



Fig.53-54:All steps are finished.

