

Griffin BALSAWOOD AIRPLANE

(GLIDER)

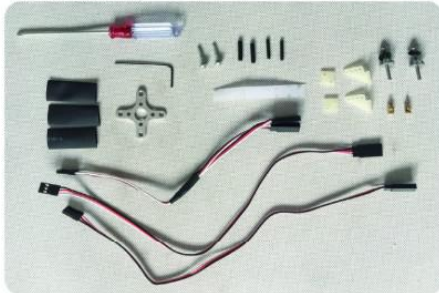

ACCESSORIES



SPECIFICATION

Wingspan:1550mm
 Length:820mm
 Flying Weight:~650g
 Suggested Motor:2212 1100Kv
 Suggested ESC:3S 30A

Suggested Prop:8 inch
 Suggested Servo:9g*4
 Suggested BATT:3S
 1300-1500mAh

TOOLS NEEDED



1. Wing Assembly

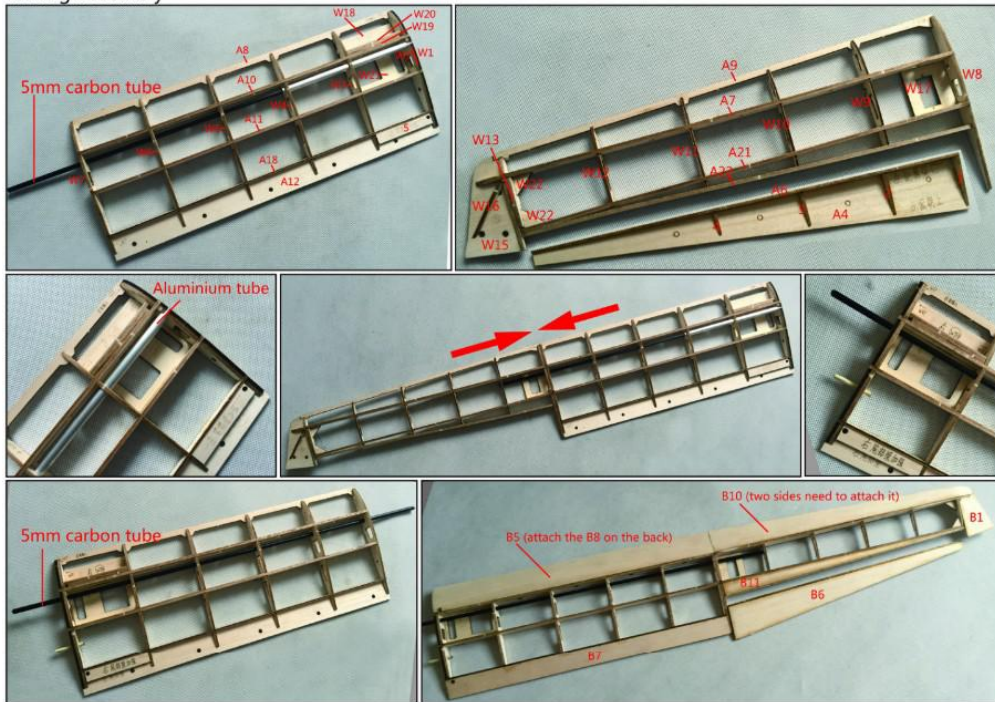

2. Fuselage Assembly



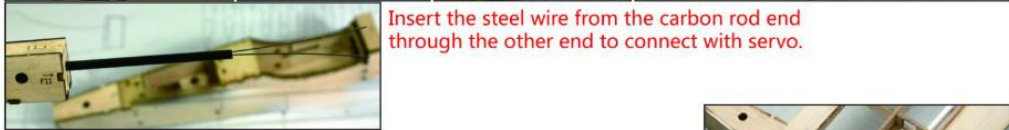
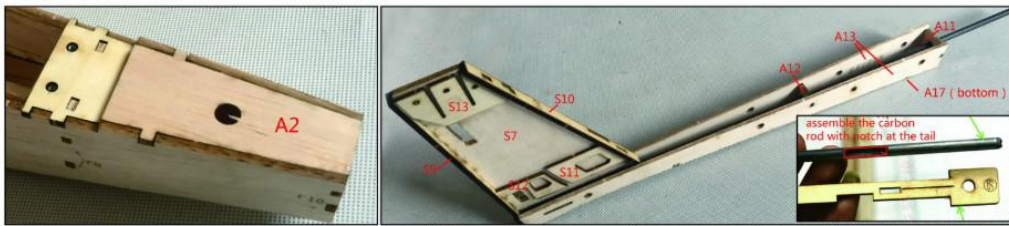

3. Whole plane Assembly

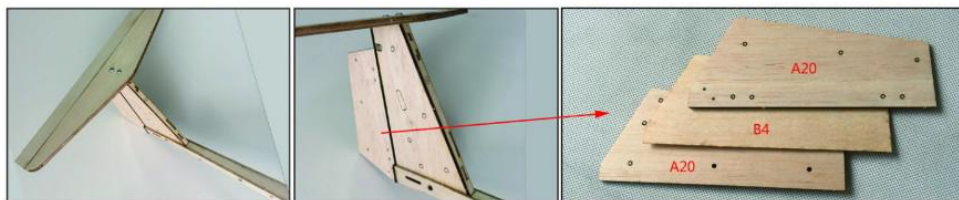
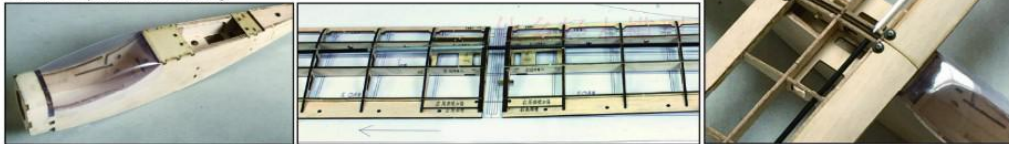

4. Power system Assembly

