

**I. Specification:**

1	Transmitting Frequency	ISM 5.6GHz - 5.95GHz 32 CH
2	Operating Voltage	+6.0V ~ +25.0V
3	Supply current	450mA/800mW/12V
4	Video Input Level	1V $\pm$ 0.2V <sub>p-p</sub> /75 $\Omega$
5	Audio Input Level	0.5 ~ 2.0V <sub>p-p</sub> /10K $\Omega$
6	TV System	PAL/NTSC/SECAM (AUTO)
7	RF Output Power	8 step adjustable(25/50/100/200/400/ 500/600/800mW)
8	Antenna Connector	SMA Connector
9	Weight	35g
10	Dimensions (L x W x H)	50x37x17mm
11	Operating Temperature	-10°C ~ +85 °C

**Operating Frequency Table**

GROUP \ CH	CH 1	CH 2	CH 3	CH 4	CH 5	CH 6	CH 7	CH 8
	A	5865MHz	5845MHz	5825MHz	5805MHz	5785MHz	5765MHz	5745MHz
b	5733MHz	5752MHz	5771MHz	5790MHz	5809MHz	5828MHz	5847MHz	5866MHz
c	5705MHz	5685MHz	5665MHz	5645MHz	5885MHz	5905MHz	5905MHz	5945MHz
d	5740MHz	5760MHz	5780MHz	5800MHz	5820MHz	5840MHz	5860MHz	5880MHz

**2. Features:**

- ❖ 32 Channel
- ❖ Solved the burning problem of high power transmitter
- ❖ LCD display, Frequency and channel synchronous display
- ❖ RF Power output 8 step adjustable(25/50/100/200/400/500/600/800mW)
- ❖ Large input voltage range
- ❖ Size: 50 x 37 x 17mm

## 5.8GHz RF Power Adjust Transmitter

### 3. Operation and Figures

#### KEY

**Group/RF Power(1)** Short press button to select a different frequency groups, namely A, b, c, d;

Press button 5S, Into the RF power adjustment mode;

IN RF power adjustment mode: press the button for up.

**Channel/Down(2)** Short press button to select a different channel, I -- 8 ;

In RF power adjustment mode: press the button for Down.

#### Jack

AV IN: Video(6) (Yellow) input and  
Audio(7) (White)

DC IN(4): +6V~+25V DC IN (Red and Black)

ANT(3): 5.8GHz dedicated antenna (SMA ANT)

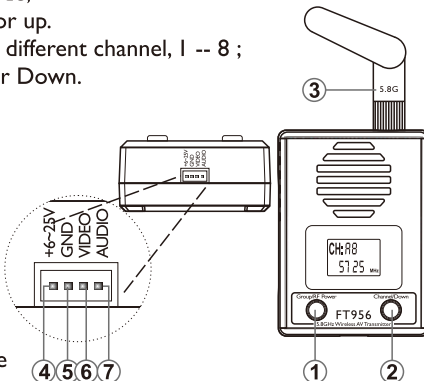

### 4. Work Mode:

**CH:RB**  
**5125 MHz**  
Frequency and channel adjustment mode

**CH:RB**  
**PA:800**  
RF Power adjustment mode(Press button 5S Group/RF Power Key)

**CE** **FC** FCC ID:2ACS9-FT95

This device complies with Part 15 of the FCC Rules.

Operation is subject to the following two conditions: (1) this device may not cause harmful interference, and (2) this device must accept any interference received, including interference that may cause undesired operation.

**Note:** This equipment has been tested and found to comply with the limits for a Class B digital device, pursuant to Part 15 of the FCC Rules. These limits are designed to provide reasonable protection against harmful interference in a residential installation. This equipment generates, uses and can radiate radio frequency energy and, if not installed and used in accordance with the instructions, may cause harmful interference to radio communications.

However, there is no guarantee that interference will not occur in a particular installation. If this equipment does cause harmful interference to radio or television reception, which can be determined by turning the equipment off and on, the user is encouraged to try to correct the interference by one or more of the following measures:

Reorient or relocate the receiving antenna.

Increase the separation between the equipment and receiver.

Connect the equipment into an outlet on a circuit different from that to which the receiver is connected.

Consult the dealer or an experienced radio/TV technician for help.

**Warning:** Changes or modifications to this unit not expressly approved by the part responsible for compliance could void the user's authority to operate the equipment.